

## LUDHIANA IMPROVEMENT TRUST LUDHIANA

### Demand Survey for allotment of multistoreyed HIG & MIG flats at Atal Apartment (8.80 acre scheme)

To assess the demand of Multistoreyed HIG and MIG flats at Atal Apartments (8.80 Acre scheme ) measuring approximately 1500 Sq.ft. and 1200 sq.ft. respectively, the Improvement Trust Ludhiana invites application from general public on the prescribed form. The form and proposed layout plan/ site plan for these flats can be obtained from Trust office on any working day or can be downloaded from website [www.ludhianaimprovementtrust.org](http://www.ludhianaimprovementtrust.org) . The estimated cost of HIG and MIG flats can be approx as 45.00 lacs and 35.00 lacs respectively . The complete form along with fees of Rs. 10,000/- in the shape of demand draft in the name of Chairman , Ludhiana Improvement Trust, Ludhiana should reach trust office upto 31-01-2019. The allotment of 50 % of the total HIG/MIG flats will be made through draw of lots as per prevailing rules/ instructions of Department of Local Government,Punjab.

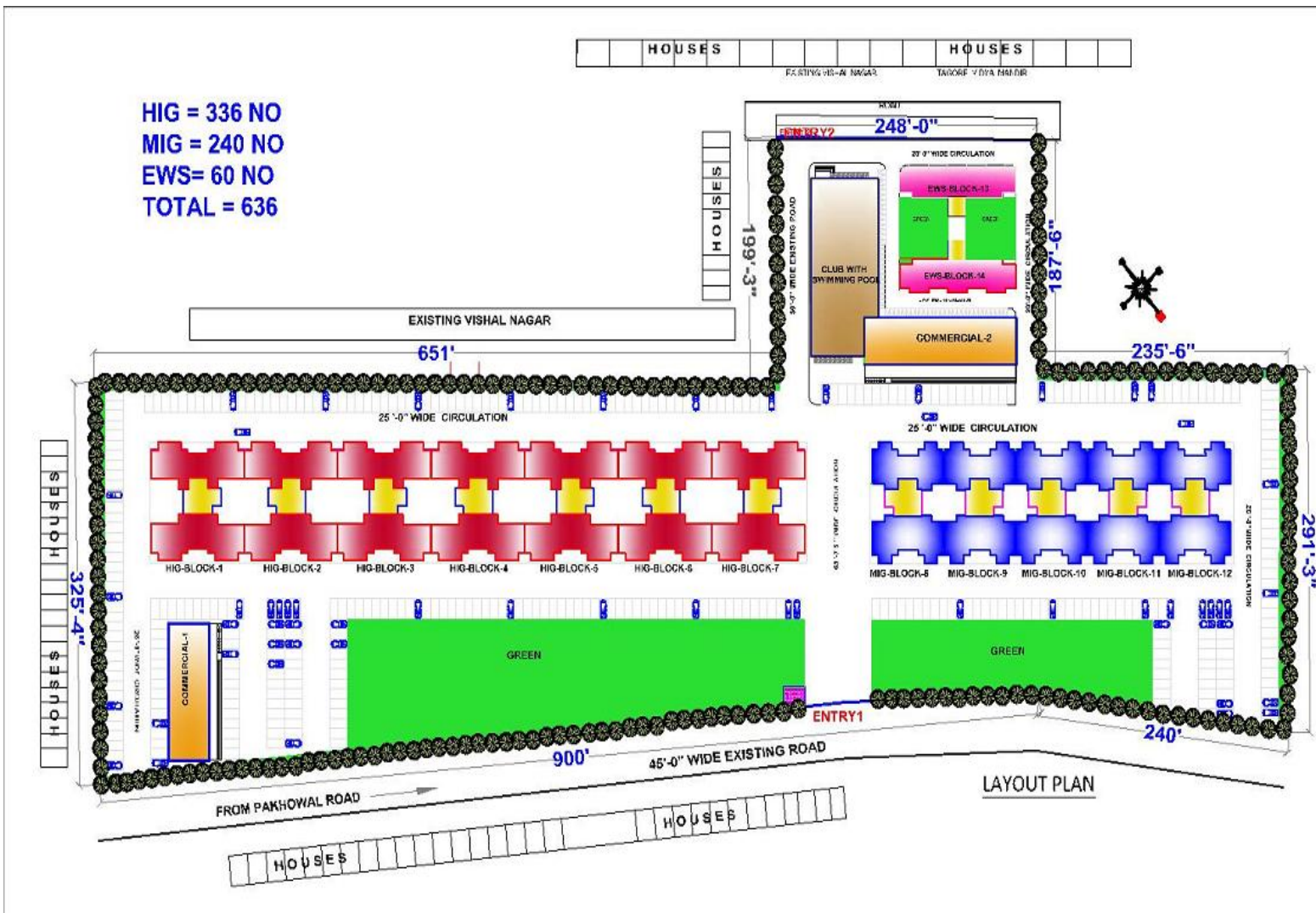

**SITE PLAN**

**No. of Floors= 12**

If the number of applicant who applied in demand survey are more than the number of offered flats to be allotted through draw of lots as per rules then the draw of lots will be held only among the applicant who have applied in demand survey after depositing requisite balance earnest money .

- Note:-
1. This is Tentative Planning. This office may change/amend layout without any prior notice.
  2. Tentative reserve price for HIG/MIG flats will conveyed at the time of draft of lots.

-sd/-  
 Chairman  
 Improvement Trust  
 Ludhiana